

龙锦二街口袋公园

LONG JIN SECOND STREET SMALL PARK

概况与现状分析
GENERAL ANALYSIS



地块位于北京市昌平区霍营街道龙锦二街和谐家园一区段路北，变电站南侧。在勘察现场时发现，沿龙锦二街两侧住宅集中，每个小区都相对面积都很大，自己都有一定绿地，但是都被各自的围墙封闭。只有东边路有较宽的，可以称为公园的绿带，里边有园路和一些小广场，小型活动场。但是，从距离上无法满足龙锦二街沿线的小区居民休闲、散步的需求，沿路近1.5公里的范围内，找不到一个可以散步或休憩的公共空间。同时，附近的居民也表达了，他们最希望的就是能有一个能散散步，稍作休憩的户外空间。

The site locates at Beijing Chang Ping District Huo Ying Street Long Jin second Street He Xie Residential, at the north side of the road, south to a large transformer substation. Along Long Jin second Street , there are many residential areas, population is a quite large number, every residential area are enclosed by fence walls, inside the wall there are some small open spaces, but outside walls, it is hard to find a public open space to just have a walk or even just have a rest. Interview also shows that a public open space for leisure is what residents here want.

场地需求分析
SITE ANALYSIS

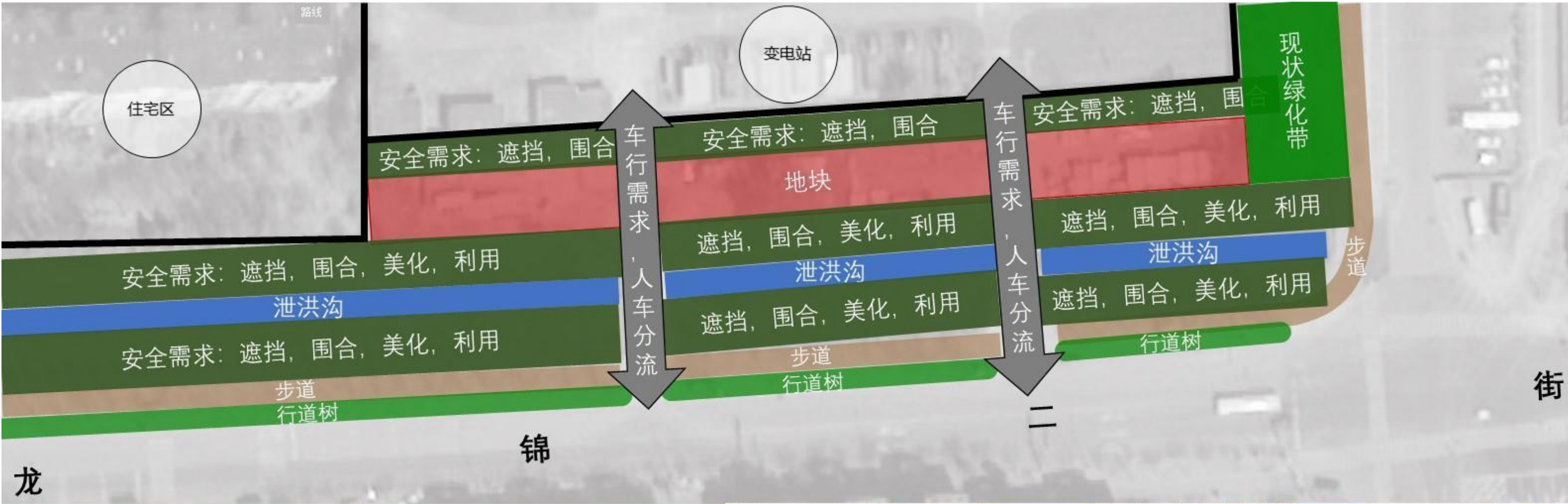

地块是一个东西长，南北短的长方形，北边一条长边是变电站的围墙，且有大门，在今后很长时间内依旧有进出车辆的需求；南边另一条长边则是泄洪沟，泄洪沟两侧有少量护岸绿化，因为安全需要，绿化外侧还有围栏。场地的西边就是旁边小区的围墙，东边则有一部分与南北向的一条现状绿化带相连。

It is a rectangle site with west to east long and north to south short. Northern long edge is the wall and gates of transformer substation, and there are 2 entrance for station's vehicles; along the other long edge, there is regional flood ditch enclosed by plants and fence. West edge is residential fence wall, and east connects with a large public green belt.

对应需求的景观空间结构
LANDSCAPE STRUCTURE

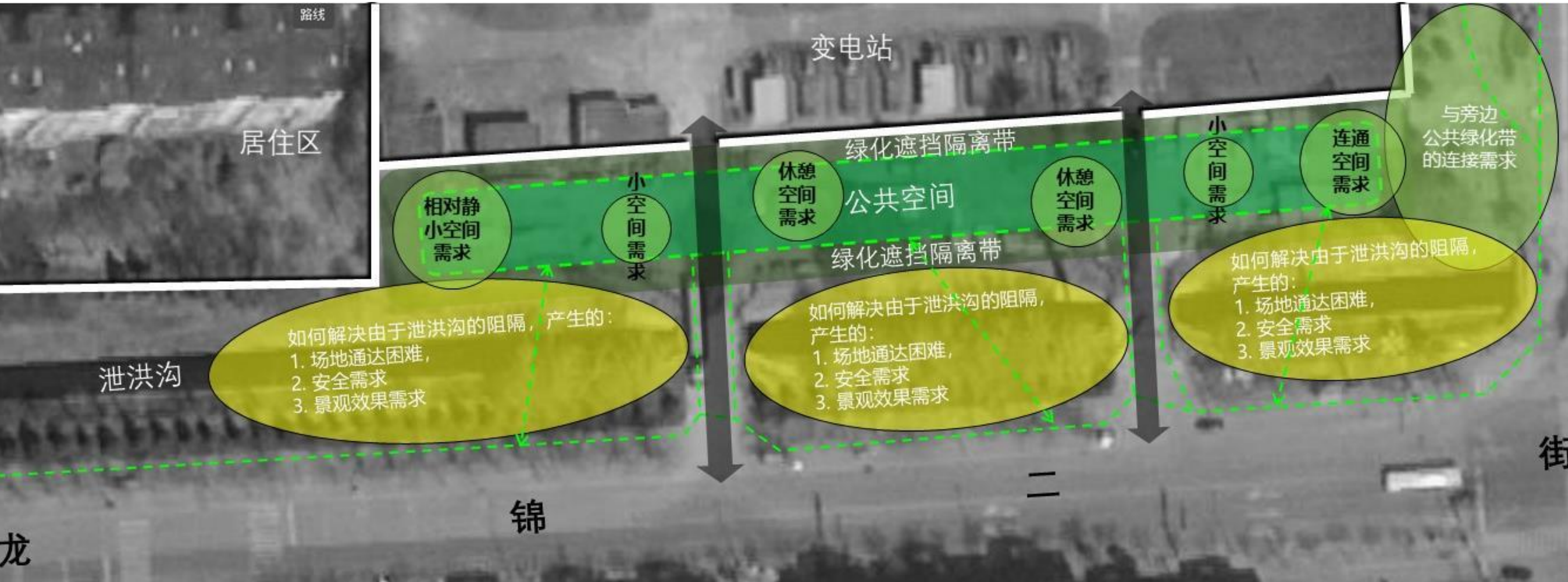

经过踏勘和场地分析，并且听取附近居民的需求后，我们了解到居民们并不希望有太多的“外来访客”，他们需要的不是一个拥有众多功能的“网红打卡点”，而是能提供散步、休憩功能的公共空间。对于一块能散步，可以稍作停留的公共空间的需求，几乎每个受访居民都提到了。而且，场地本身就很很小，在这样一个小小的地块，填鸭式塞进过多功能意义不大。

景观上着重解决以下几个主要问题与需求：

- 1. 为附近居民提供一个可以休闲散步的，且步行安全友好的公共空间；
- 2. 因泄洪沟产生的步道与场地通达不便的问题；
- 3. 泄洪沟周边的安全问题；
- 4. 如何美化泄洪沟及周边，与地块内的景观公共空间融为一体

After site visiting and discussion with residents living nearby, we understand that they just want some public space can do leisure walking, the residents actually do not want many visitors. And the site is quite small, cannot contain too much function, so, our design just emphasize on below major issue:

- 1. Provide a safe & friendly public open space for residents living nearby;
- 2. Figure out how to connect site with outside of flood ditch;
- 3. Make a safe buffer for flood ditch area;
- 4. Modifying flood ditch area with good landscape and integrate it into entire landscape.

景观总平面图
LANDSCAPE PLAN

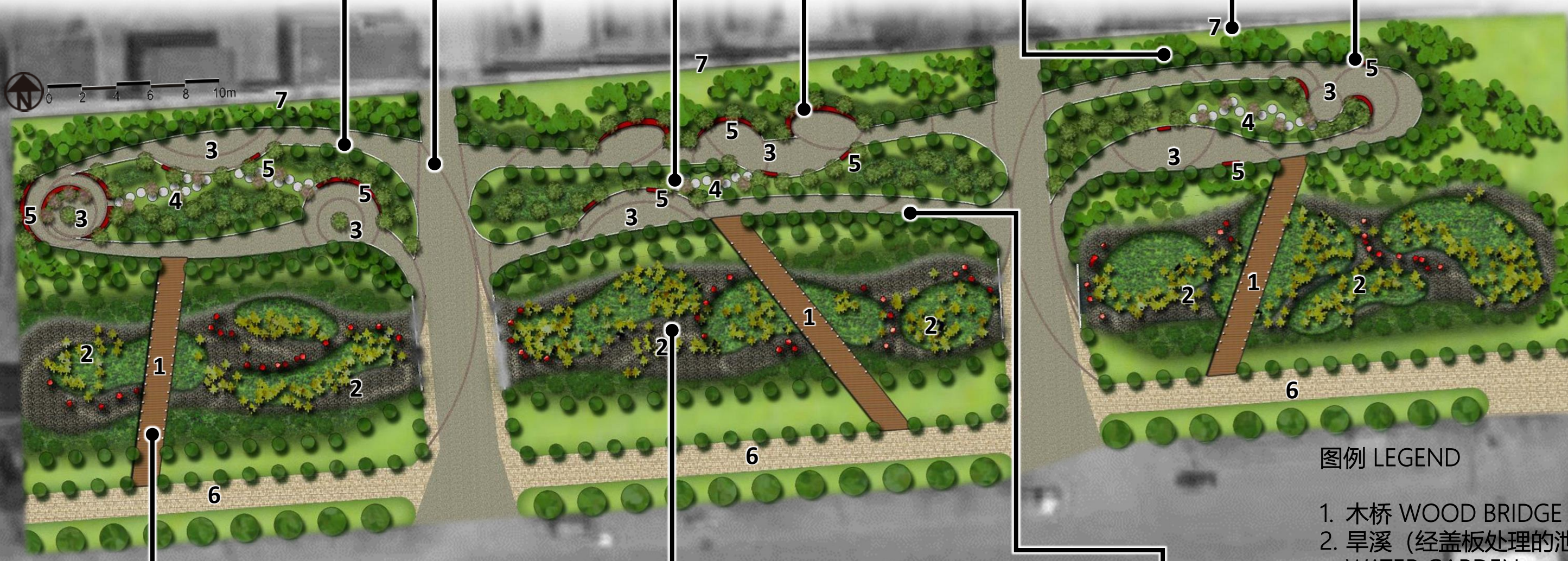

- 图例 LEGEND
- 1. 木桥 WOOD BRIDGE
 - 2. 旱溪 (经盖板处理的泄洪沟) WATER GARDEN
 - 3. 休憩空间 OPEN SPACE
 - 4. 趣味林荫汀步 STEPS
 - 5. 创意座椅和坐凳 SEAT
 - 6. 外围沿路步行道 PEDESTRAIN
 - 7. 变电站围墙 WALL

动线分析
CIRCULATION

建成后可与东侧
绿化带步道相连



景观设计了成环的园路在口袋公园中，一圈全长约300米，沿路安排了多个休憩空间，可以满足散步及休憩需求。在泄洪沟的处理上，提出一个实验性的做法：在泄洪沟上覆盖称重的有孔钢筋混凝土板，在用大小不一的自然石、砾石、砂砾及种植土，运用旱溪及雨水花园的做法，不仅可以保证泄洪沟快速渗水功能，又可以在保证安全的前提下，打开景观视线，将泄洪沟区域的景观与公园融合成为一个整体。并且用木桥把外围的沿街步道与内侧的成环路连接起来，方便附近居民进入口袋公园。（此做法仅为建议，泄洪沟也并未包含在设计范围内，泄洪沟区域按现状不动，并不影响设计范围内的景观实施）

The walking path inside park can be connected into a more than 300 meters circle walking path, and there are several open spaces along the path. We use landscape approach to make flood ditch into rain garden to not only respect it's function but also provide pretty landscape view, and integrating the entire area's landscape style. There are 3 wood bridge to connect outside street pedestrian with inside park's walking path to provide friendly walking experience.

场地横剖面图
SECTION

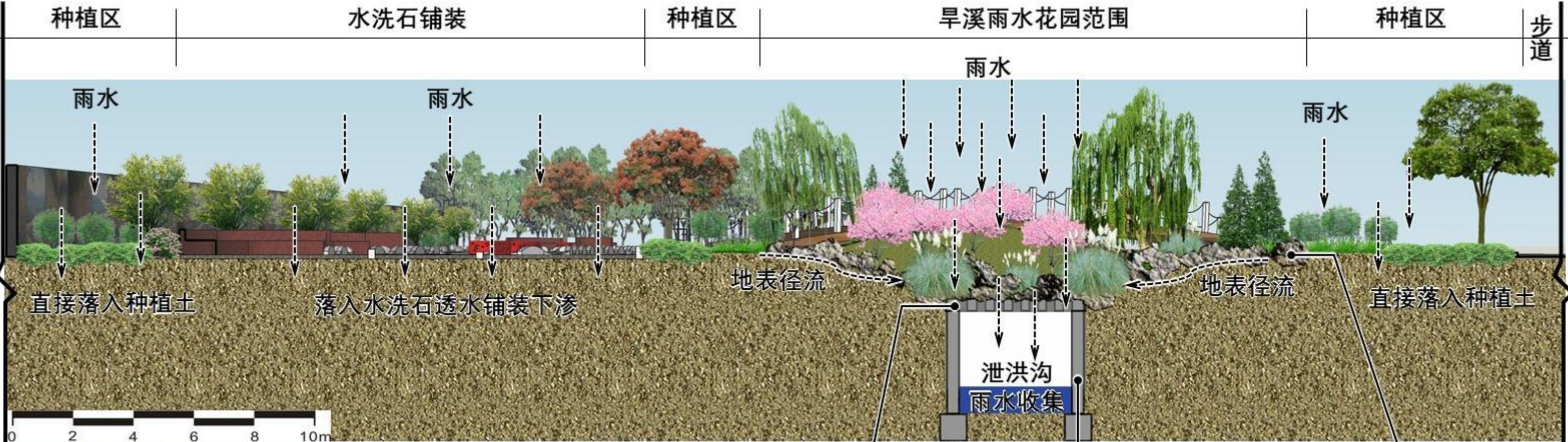

在硬质材料的选择上，注意选用较生态环保，且易于施工，便于养护的材料；色彩上选择较艳丽且颜色较深，不易脏，容易养护的颜色。

Using eco material and bright but colorful hardscape material.

效果图-东鸟瞰
RENDERING

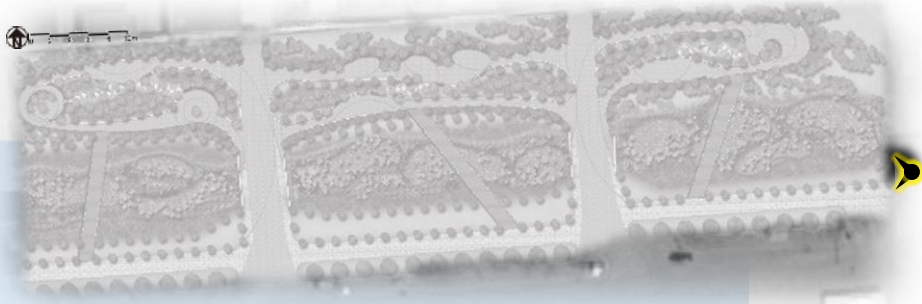

效果图-西鸟瞰
RENDERING

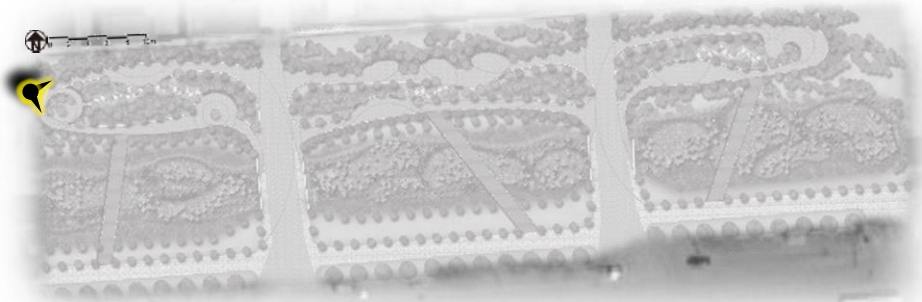

效果图
RENDERING

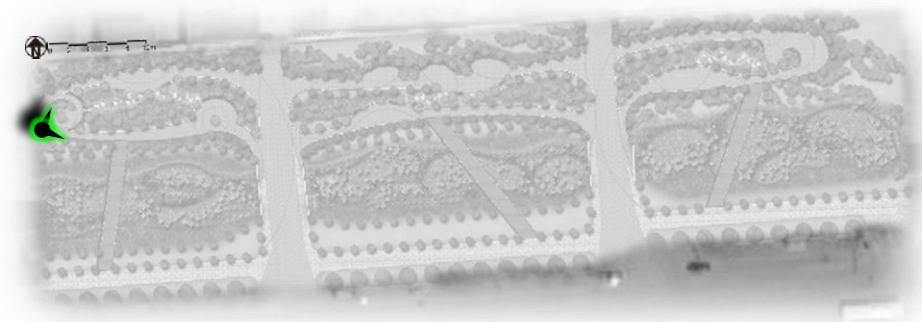

效果图
RENDERING

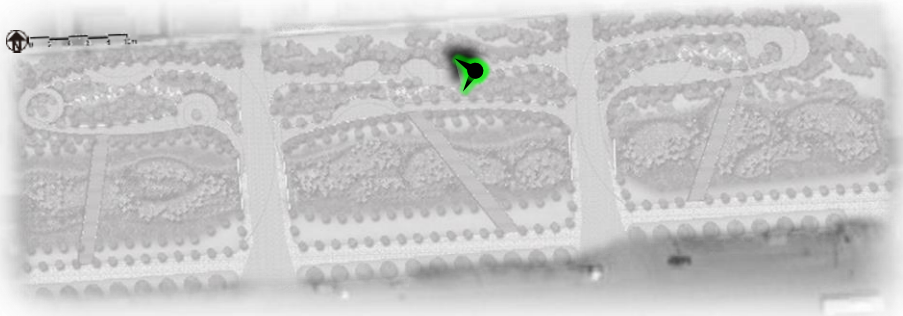

效果图
RENDERING

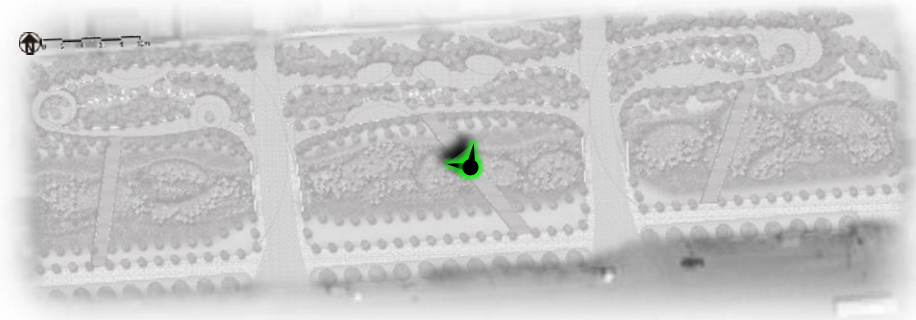

效果图
RENDERING



效果图
RENDERING



景观其他部品意向
LANDSCAPE ELEMENTS



趣味雕塑 SCULPTURE



地面标识 MARKS



分类垃圾桶 WAST BOX



路灯
LIGHT

可以布置一些趣味雕塑在旱溪或者种植区内，与植物相互掩映，增加沿路趣味性景致。
水洗石的可塑性和图案性都很强，而且目前已经有很多颜色，建议标识可以做成融入水洗石铺装中，做成地面标识，增加趣味性，且节省空间和造价。
景观灯不易布置过多，仅沿环形散步道布置路灯，满足照明需求即可。

It will be great fun to put some serial small sculptures into plants areas or rain garden areas; marks in the paving can save space and cost; there should be enough lights along walking path.

植物选择建议 ——乔木及单株灌木
PLANTING – TREE & SINGLE SHRUB



垂柳
Salix babylonica



栾树
Koelreuteria paniculata



山桃
Prunus davidiana



刺槐
Robinia pseudoacacia

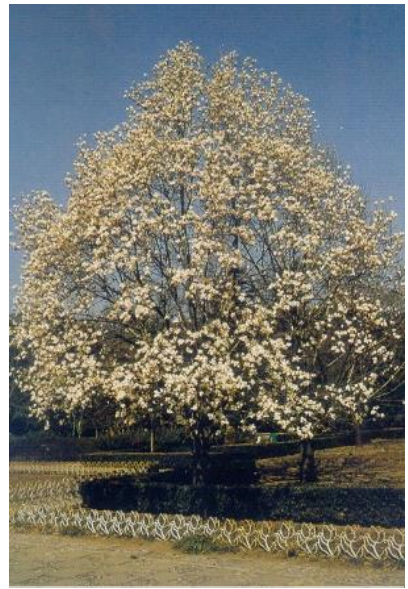

白玉兰
Magnolia denndata



圆柏
Sabina chinensis



碧桃
Amygdalus persica f.



榆叶梅
Amygdalus triloba



迎春
Jasminum nudiflorum



连翘
Forsythia suspensa



紫丁香
Syzygium aromaticum



珍珠梅
Sorbaria sorbifolia



天目琼花
Viburnum opulus f.



木槿
Hibiscus syriacus

植物全部使用本土树种，适地
适树，抗性强，且易于养护管
理。

Suggest use local plants to reduce cost
for maintenance.

植物选择建议 ——片植灌木及地被
PLANTING – SHRUB & GROUNDCOVERS



铺地柏
Sabina procumbens



金叶女贞
Ligustrum x vicaryi



黄菖蒲
Iris pseudacorus



玉簪
Hosta plantaginea



粉花绣线菊
Spiraea japonica



红瑞木
Swida alba



平枝栒子
Cotoneaster horizontalis



鸢尾
Iris tectorum



狼尾草
Pennisetum alopecuroides



八宝景天
Hylotelephium erythrostictum



粉黛乱子草
Muhlenbergia capillaris



苔草
Carex spp.



矢羽芒
Miscanthus sinensis var.purpururascens